

Model and Description

LX	KLT	2	<input type="checkbox"/>	<input type="checkbox"/>
Model	Two-way pull-cord Switch	Design No.	Reset mode	Contact form
			1: Automatic reset	1: 1NO+1NC
			2: Manual reset	2: 2NO+2NC

Application and Feature

LX-KLT2 switch is applied to the belt conveyer, works as emergency stop when a accident occurred.

Specification

Contact form:	1NO+1NC or 2NO+2NC
Contact capacity:	5A 380VAC
Reset mode:	Automatic rest or Manual rest
Motion angle:	30°
Limit angle:	60°
Operating force:	10kgf
Mechanical life:	$\geq 10 \times 10^5$ (Frequency: 106 times/min)
Ambient temperature	-30°C ~ +75°C
Relative humidity	$\leq 85\%$
Weight	Appr. 2.5kg

Mounting

Wiring

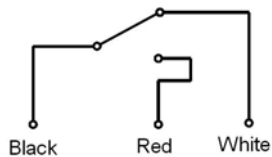

Mounting

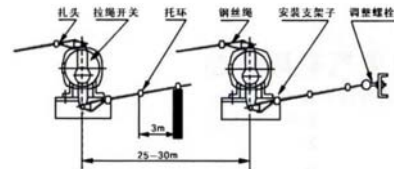

Dimension

LX-KLT2/21

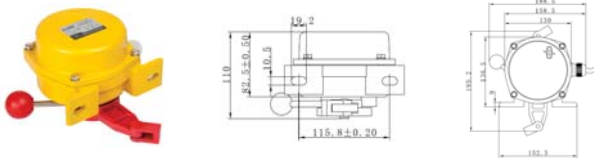

LX-KLT2/11

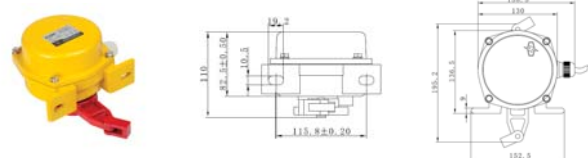

LX-KLT2/22

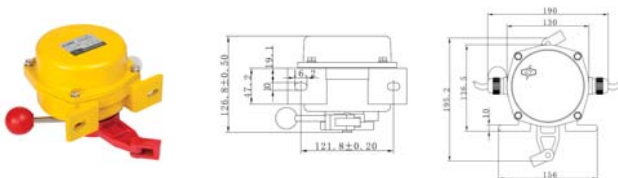

LX-KLT2/12

